

# singing rock

## FRANKLIN

Code  
W0010YB00



Reading and understanding instruction for use are required to use this product!  
Bez důkladného prečtení a pochopení návodu k použití nepoužívejte tento výrobek

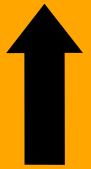

Seat for working in height

CE 0123



SIZE	uni
A [cm]	46
A [in]	18
B [cm]	16
B [in]	6
m [g]	1650

Používej pouze v kombinaci se sedacím úvazkem (EN 813)  
Use only with sit harness (EN 813)

EC QMS of production inspected by /  
ES SRJ výroby prověřuje

TÜV Product Service GmbH  
München, Germany

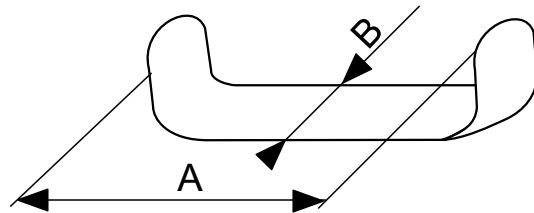

3 years guarantee  
3 roky záruka

### Technical description

- comfortable seat for working in height
- gear loops made of steel D ring - maximum load 50 kg each
- adjustment of anchor webbing with buckle Rock Lock
- maximum safety working load of seat 250 kg
- maximum load a test description 350kg
- textile gear loop for fixing of seat to harness at walking
- inner support made of glass fibre
- **use only with sit harness EN 813**

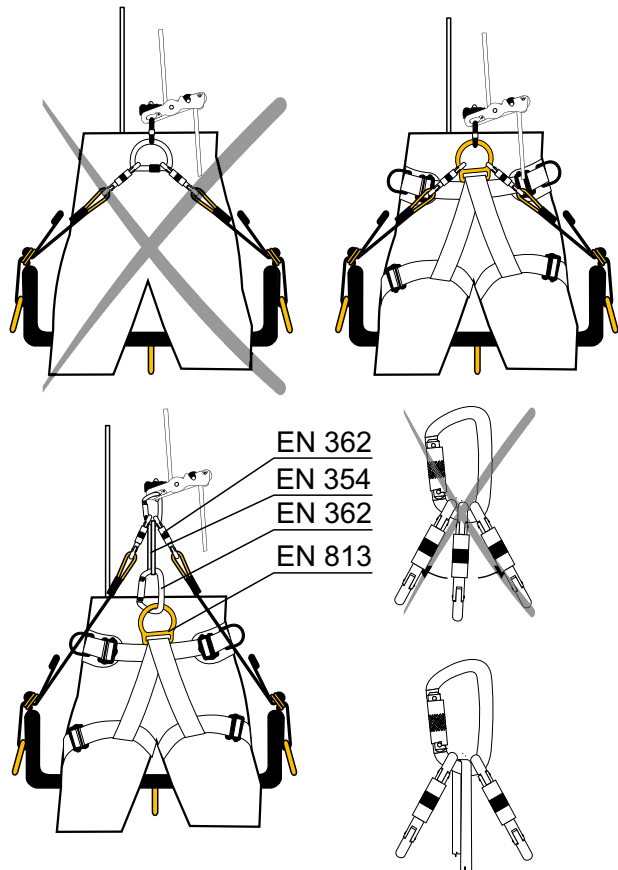
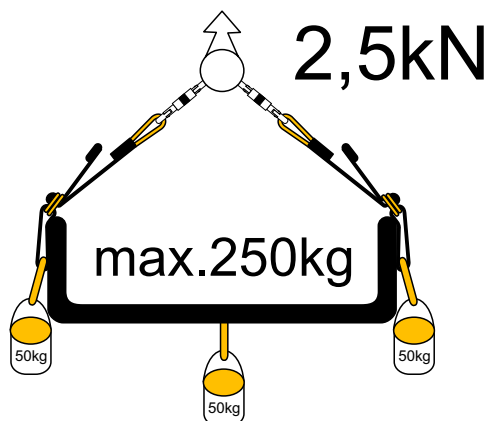

### Rock & Lock buckle

Only small effort of your fingers is needed to lock and open.

1. Make the loop and put it through the buckle frame.
  2. Hook the loop on cross bar.
  3. Tighten.
- It is easy as that.



**ROCK  
&  
LOCK**

[www.singingrock.com](http://www.singingrock.com)

SAFETY  
FIRST